



# HIGHWAYS ADVISORY COMMITTEE

14 April 2015

# REPORT

**Subject Heading:**

Proposed Pay & Display parking provisions – comments to advertised proposals  
**TPC507 – Crow Lane**

**Report Author and contact details:**

Mitch Burgess – Engineering Technician  
schemes@havering.gov.uk

**The subject matter of this report deals with the following Council Objectives**

Clean, safe and proud borough	<input checked="" type="checkbox"/>
Excellence in education and learning	<input type="checkbox"/>
Opportunities for all through economic, social and cultural activity	<input checked="" type="checkbox"/>
Value and enhance the life of every individual	<input checked="" type="checkbox"/>
High customer satisfaction and a stable council tax	<input type="checkbox"/>

**SUMMARY**

This report outlines the responses received to the advertised proposals to change the existing Voucher parking bays in Crow Lane, Romford to Pay & Display parking bays.

## RECOMMENDATIONS

1. That the Committee having considered this report and the representations made recommends to the Cabinet Member for Environment that the following measures be implemented as advertised:
  - (a) to change the existing voucher parking bays in Crow Lane, Romford as shown on the drawing in Appendix 1 of this report to Pay and Display parking bays.
  - (b) that the effect of the scheme be monitored.
  
- 2) That Members note that the estimated cost of Pay & Display parking in Crow Lane as set out in this report is £4,000 and can be funded from the capital allocation;

## REPORT DETAIL

### 1.0 Background

#### Crow Lane – Pay & Display (Romford)

- 2.0 At its meeting in October 2014, this committee agreed in principle to the conversion of the existing voucher parking bays in Crow Lane, Romford as shown on the drawing at Appendix 1 to Pay & Display parking bays.

The request was put forward to deter long term parking in Crow Lane.

### 2.1 Outcome of Public consultation - Responses received

At the close of public consultation on the 5<sup>th</sup> December 2014, 0 responses were received to the proposals. During the course of the consultation 7 properties were consulted.

### 3.0 Staff Comments

The introduction of pay and display is designed to deter long term parking and will benefit visitors to local residents and business in the area. Officers recommend that the proposals should be implemented as advertised.

## IMPLICATIONS AND RISKS

### **Financial implications and risks:**

This report is asking the Highways Advisory Committee to recommend to the Lead Member the implementation of the above scheme.

The estimated cost of implementing the proposals as described above and shown on the attached plan is £4000 including advertising costs. This cost can be met from the Streetcare capital allocation

The costs shown are an estimate of the full costs of the scheme. Should it be implemented a final decision would be made by the Lead Member with regards to actual implementation and scheme detail. Therefore, final costs may be subject to change.

This is a standard project for StreetCare and there is no expectation that the works cannot be contained within the cost estimate. There is an element of contingency built into the financial estimate. In the unlikely event of an overspend, the balance would need to be contained within the capital allocation.

### **Legal implications and risks:**

The proposal of Pay & Display bays requires a consultation, the advertisement of proposals and consideration of the responses before a decision can be taken on their introduction.

### **Human Resources implications and risks:**

The proposal can be delivered within the standard resourcing within Streetcare, and has no specific impact on staffing/HR issues.

### **Equalities implications and risks:**

The proposals included in the report have been publicly advertised and subject to public consultation. All residents who were perceived to be affected by the proposals have been consulted informally and formally by letter and plan. Eighteen statutory bodies were also consulted and site notices were placed at the location.





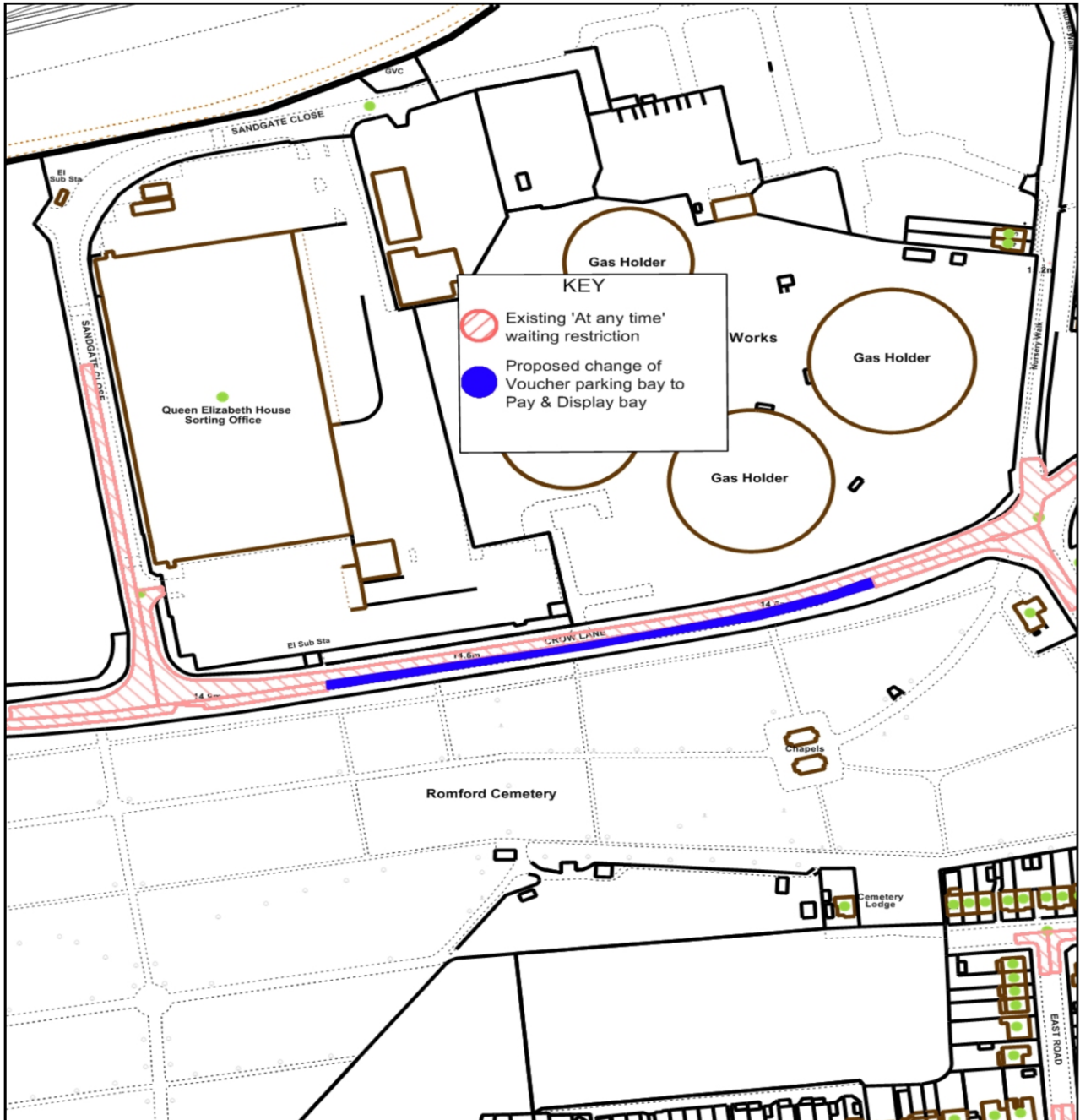

After careful consideration officers have recommended that all proposals be implemented as advertised and the effects be monitored to ensure any equality negative impact is mitigated.

There will be some physical and visual impact from the required signing and lining works. Where infrastructure is provided or substantially upgraded, reasonable adjustments should be made to improve access for disabled people, which will assist the Council in meeting its duties under the Equality Act 2010.

Staff will monitor the effects of these proposals and if it is considered that further changes are necessary, the issues will be reported back to this Committee so that a further course of action can be agreed.

**BACKGROUND PAPER**

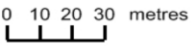

<p>Crow Lane</p>	
   <p>The National Land &amp; Property Gazetteer NATIONAL STREET GAZETTEER Ordnance Survey Licensed Partner</p>	<p>Scale: 1:2000</p> <p>Date: 11 November 2014</p> 
 <p>London Borough of Havering Town Hall, Main Road Romford, RM1 3BD Tel: 01708 434343</p>	<p>© Crown copyright and database rights 2014 Ordnance Survey 100024327</p>